

charder®

Caution Note

- **Please follow CORRECT assembling procedures**

Please PREPARE one hexagon screwdriver and one torque wrench

- ① HOLD / Fix one side
- ② The other side to be screwed in tightly.
(and then do the same for another side)

HIGHLY ATTENTION: Torque must be 18kgf-cm ± 1kgf-cm

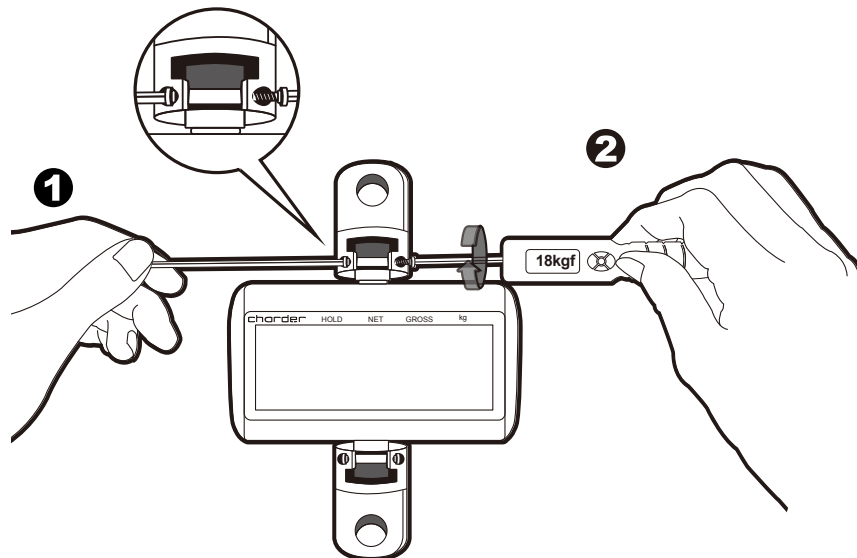

- **Check if the nylock screws are fully tightened**

- ③ Do not use the life scale when the screw is loose
- ④ Must be fully screw-in

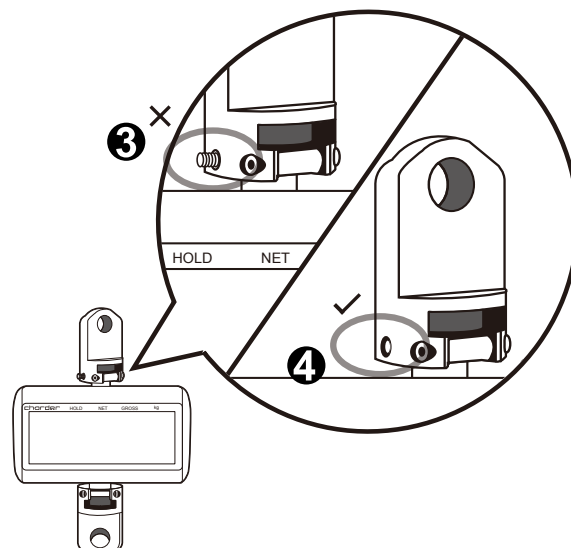

Attention

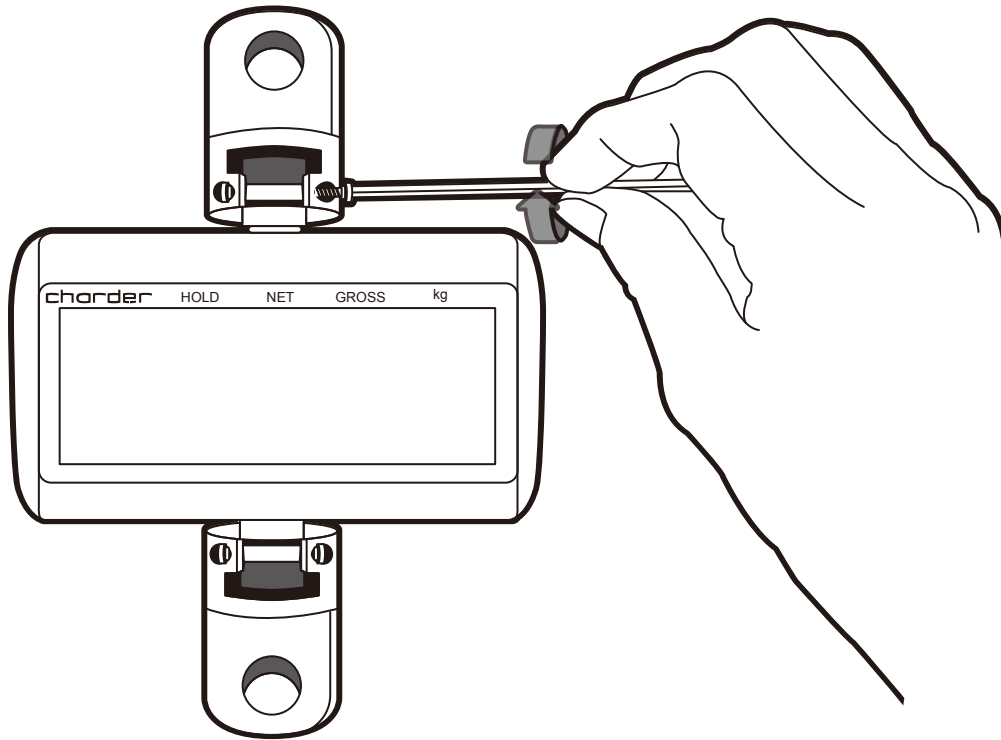

It is highly ***PROHIBITED*** if using one side screw-in only as the joint will not be fixed which may cause unexpected injuries or incidents on the lift scale / system.

charder[®]

CHARDER ELECTRONIC CO., LTD.

NO.103 KUO CHUNG ROAD, DALI DISTRICT, TAICHUNG CITY 41262, TAIWAN

TEL: +886(4) 24063766 FAX: +886(4) 24065612