

We are not aware of any cases in which such an incident has resulted in patient harm. However, to ensure that the DIN plug for CO2 fully complies with the requirement of the standard, a design adjustment will be introduced.

Actions:

We have modified the design of the connection plug according to the DIN standard for CO2 enabling the use of a different filter solution and the widening of the bore hole to $\varnothing 5.9$ mm, according to the standard.

Current situation:

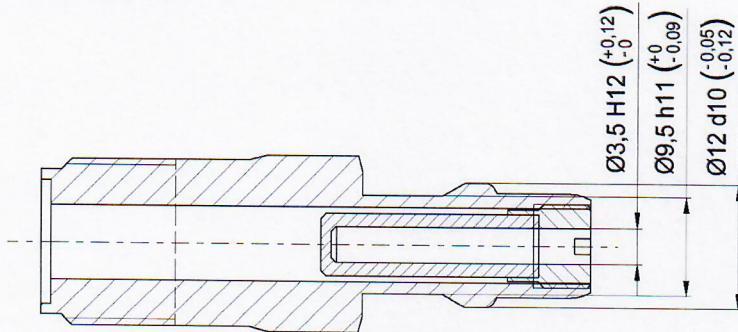

New connection plug:

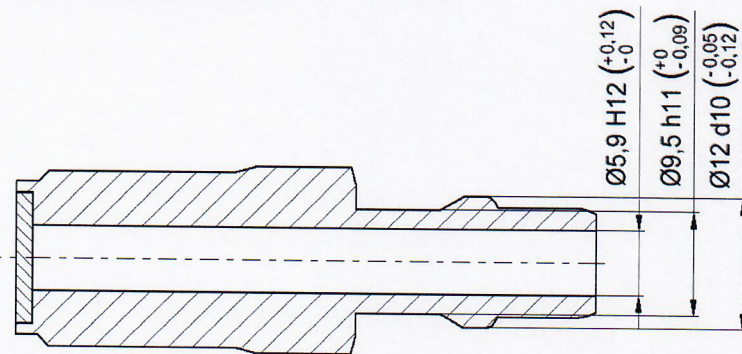

You will be informed about the product exchange as soon as it is available and the replacement has been planned accordingly.

Until then, we ask you to handle the device with special care. Make sure that you only plug the device into a CO2 terminal unit corresponding to the gas.

Please inform all other users who use the device on a daily basis of the risks and precautions described.

We apologize for any inconvenience caused and assure you that your device or devices will be replaced as soon as possible.

